

Apply school labels as shown

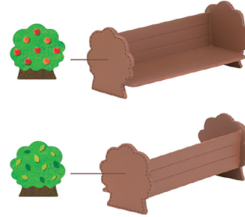

Apply bench labels as shown



Apply the "dry erase" label to the side of the board with the storage bar facing forward

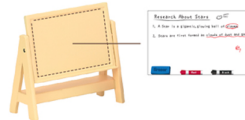

Flip the board and apply the news label to the other side of the board

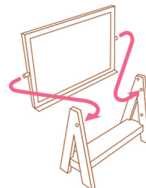

Insert the knobs of the board into the slot on the sides of the easel

Attach the walkway railing as shown

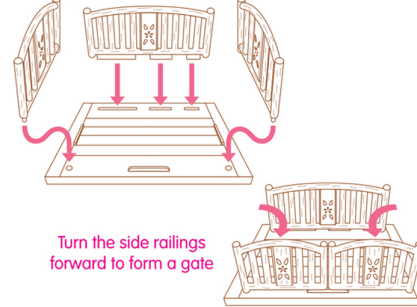

Turn the side railings forward to form a gate

Attach the tree branch to the trunk as shown

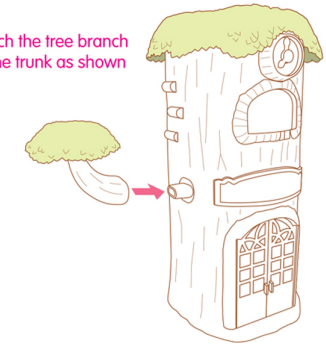

Attach the school sign as shown

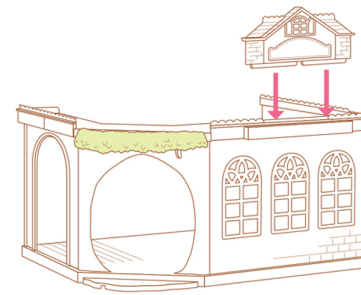

Attach the telescope in 4 different spots of the school as shown

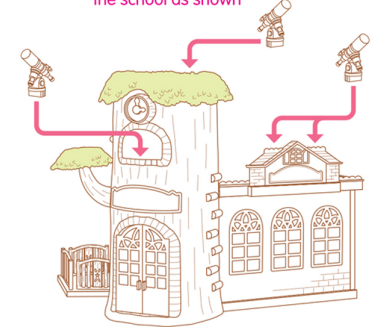

Apply book labels as shown



Assembling the science books



Fold along the dotted lines

Fold along the dotted lines
Insert the tab into the slot